

~~VOID~~ - DEC. 9, 1947
SEE CHANGES
ON DEC. 10, 1947 PLANS

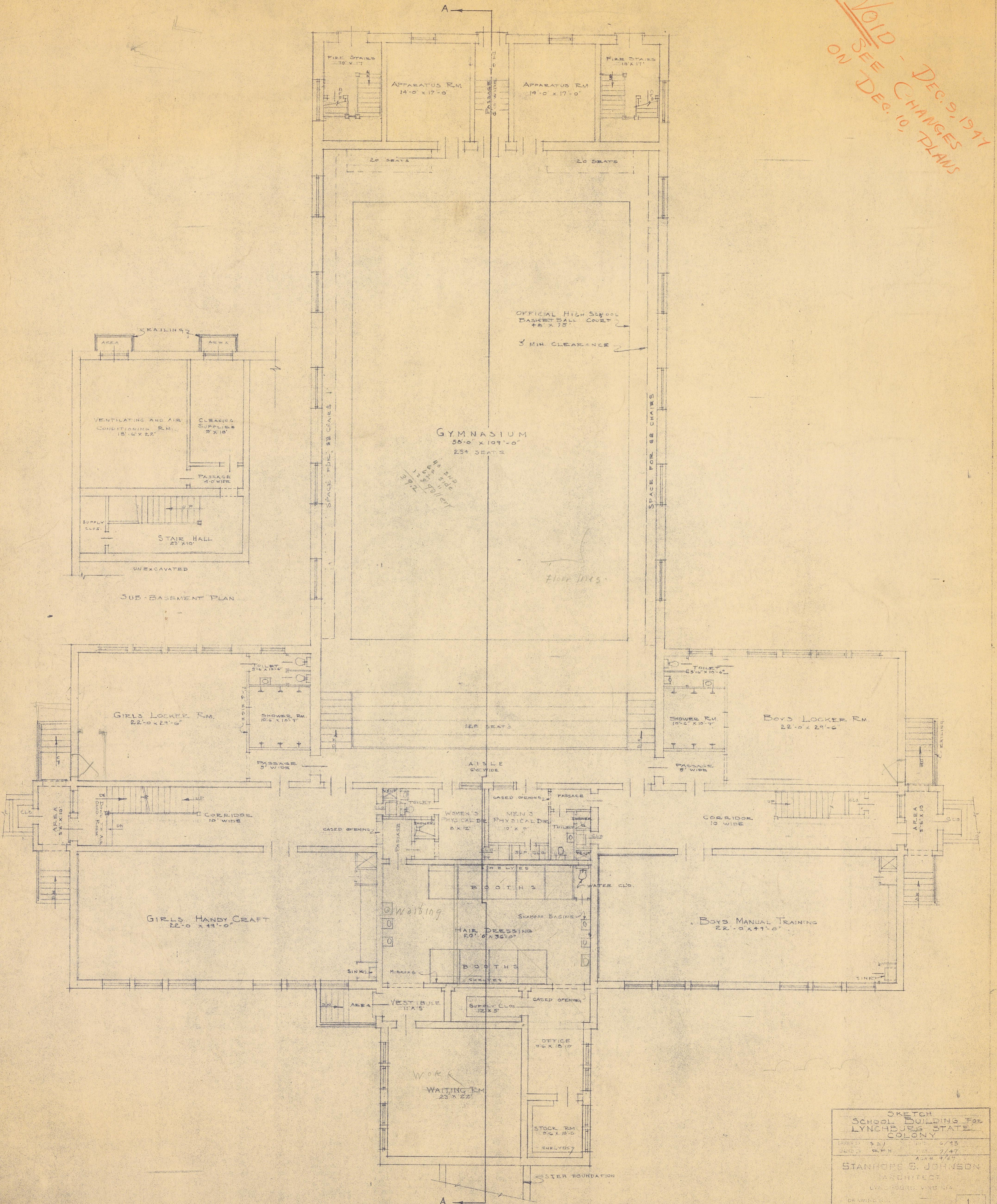

SUB-BASEMENT PLAN

GYMNASIUM
56'-0" x 109'-0"
254 SEATS

OFFICIAL HIGH SCHOOL
BASKET BALL COURT
46' x 75'

3 MIN CLEARANCE

GIRLS LOCKER RM.
22'-0" x 29'-6"

BOYS LOCKER RM.
22'-0" x 29'-6"

GIRLS HANDY CRAFT
22'-0" x 49'-0"

BOYS MANUAL TRAINING
22'-0" x 49'-0"

WAITING RM.
23' x 22'

SKETCH
SCHOOL BUILDING FOR
LYNCHBURG STATE
COLONY

DATE: 5/21	DATE: 6/13
DRAWN BY: R.H.	DATE: 7/47
ARCH: 7/47	

STANFORD S. JOHNSON
ARCHITECT
LYNCHBURG, VIRGINIA

DRAWING NO. 1